



Conference Center – Charles L. Sewall Center

Our executive conference level can accommodate meetings/events ranging in size from 2- 224 people

International Suite

Our main meeting room, the International Suite, is our largest conference room; convenient for when groups use additional break out rooms. This room can also be sub-divided into as many as five smaller rooms.

Executive Dining Room

The Executive Dining room has floor-to-ceiling windows which offer a spectacular backdrop for your meeting or gourmet meal. Like the International Suite, this room can be sub-divided into three smaller spaces.

Boardroom A & Boardroom B

Our tastefully decorated executive boardroom(s) have seating for up to 14 around boardroom table; perfect location for private meetings.

Pennsylvania Suite / Classroom 305

Classroom equipped with; computer/monitor, DVD/VCR player, projector, VGA cable for laptop connection and USB connection. Features long tables with chairs seating for up to 53.

Reception Area A&B

In addition to our meeting rooms, our conference center, offers tastefully decorated pre and post event function spaces that can be utilized for registration, buffets, displays and small gatherings.

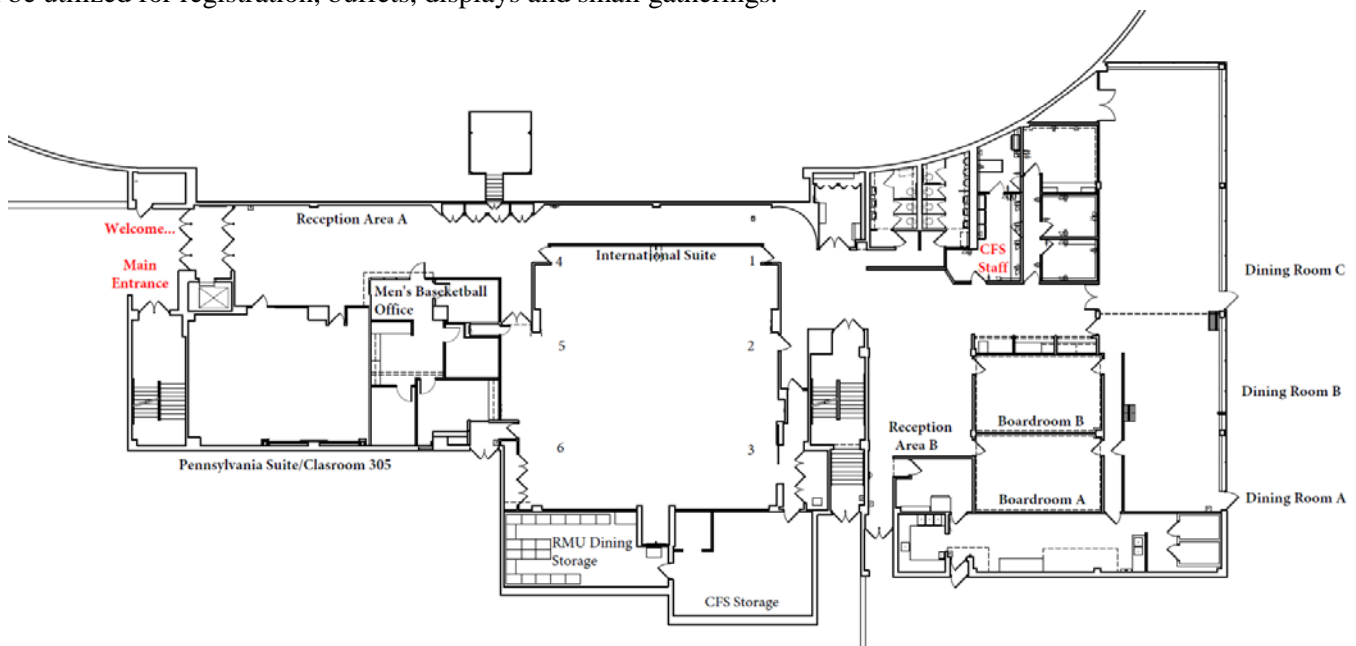

Contact us at 412-397-4445, if you would like your next conference, camp or event to surpass all expectations!



Exhibit Space – Charles L. Sewall Center

Open the doors to 36,000 square feet of unobstructed, column-free space in the Conference and Facility Services' exhibit hall. Designed for elegant banquets of 1,500, busy trade shows of up to 180 exhibitors, an evening concert for 4,000 or a multi-day seminar with multiple break-outs, the Charles L. Sewall Center is distinctive and convenient. You will work with a professional event staff member to ensure the space is prepared and all arrangements are handled according to your specifications. Free parking is available for Center events, and for out-of-town attendees' area hotels and the airport are only a few minutes away.

Capacity: Exhibition Space for 180 10'x10' booths

Power: If you have special or unique power requirements please contact us to make arrangements

Floor Load: 300 pounds per square foot

Dimensions: 146' x 242'

Communications Connections: Telephone, computer, radio, broadcast, cable, wireless internet and closed circuit television

Delivery: Ground level, roll-up door, 10' high x 11' wide, straight and level delivery drive

Lights: Metal halide. Foot candles at floor:
Area B: 125-150
Area A&C: 75-90

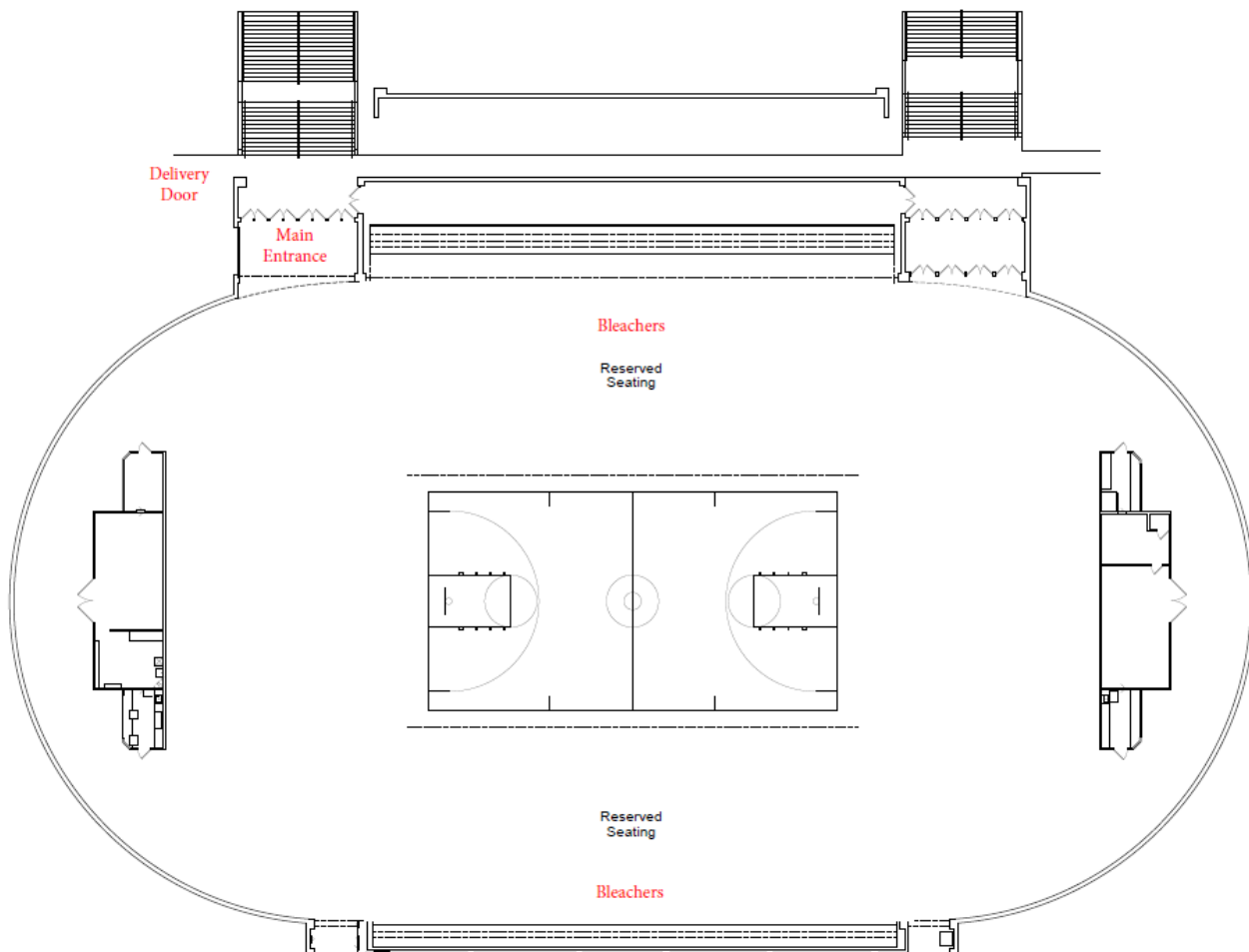

Contact us at **412-397-4445**, if you would like your next conference, camp or event to surpass all expectations!